

SHARK 150

The Shark150: our small fixture for big performances. Completely manufactured in light alloy and plastic material, with a new design and a smooth shape, with an optic system of incredible performance and a modern and reliable electronics, the Shark150 can be smartly used anywhere from small-medium discos, to exhibitions, pubs, shop-windows, bands performances ect.



SHARK 150

available versions:
art. 0001: SHARK 150

available accessories:
art. SH150 bracket: kit fast fixing bracket + 2 fast lock
art. S1/CASE: flight case for n.2 Shark 150

art. SINGLE clamp: n.1 aluminium clamp

SHARK 150 technical features

- LAMP (OSRAM) HTI 150W or HTI 152W
 - color temperature: 6.900°K
 - lamp life: 750 hours
 - BEAM ANGLE: 18°
 - PAN TILT
 - stepper motor 8 or 16 bit resolution
- 4 different speeds or real time (16 bit). 370° pan (1,5 sec.), 270° tilt (1,2 sec.)
- COLORS
 - color wheel with 7 dichroic filters + white, rainbow effect (3 different speeds)
- GOBOS
 - 1 gobos wheel with 7 effects + white

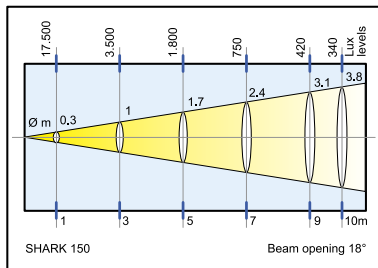

- STROBE/SHUTTER
 - mechanical with strobe effect (variable time)
- CONTROL INPUT
 - standard interface: RS-485
 - opto-coupled input
 - protocol: USITT DMX512
 - local/remote reset
 - remote switching off lamp
 - autotest of all functions
- 2 cannon connectors (3 pin male/female)
 - auto mode functioning Master/Slave
 - 4 resident programs
- SETUP: built-in microprocessor with LED display
- SAFETY SYSTEM
 - switches on for anomaly overtemperature or remote reset

- POWER SUPPLY: 230Vac/50-60Hz
 - 100Vac, 200Vac, 240Vac/50Hz; 117Vac, 208Vac/60Hz (on request)
 - 350VA, PFC built-in cosØ0.9
- DMX CHANNELS

- | | |
|--|---|
| <ul style="list-style-type: none"> (8 bit) ch1 = motors speed ch2 = colors ch3 = gobos ch4 = dimmer/shutter/strobe ch5 = pan coarse ch6 = tilt coarse | <ul style="list-style-type: none"> (16 bit) ch1 = motors speed ch2 = colors ch3 = gobos ch4 = dimmer/shutter/strobe ch5 = coarse pan ch6 = coarse pan fine ch7 = coarse tilt ch8 = coarse tilt fine ch9 = reset/remote lamp off |
|--|---|

- DIMENSIONS: (wxdxh) mm. 350x315x420
- WEIGHT: 10 kgs.

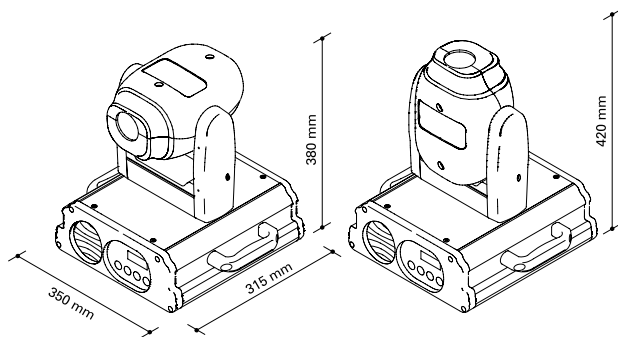

The lamp used in the SHARK is the well-known HTI 150W or the HTI 152W, and the combination of its high color temperature to the elliptical dichroic reflector make the light beam of the Shark 150 one of the brightest in this range. The lamp replacement is simple and fast, and the focus can be externally regulated through three small knobs.

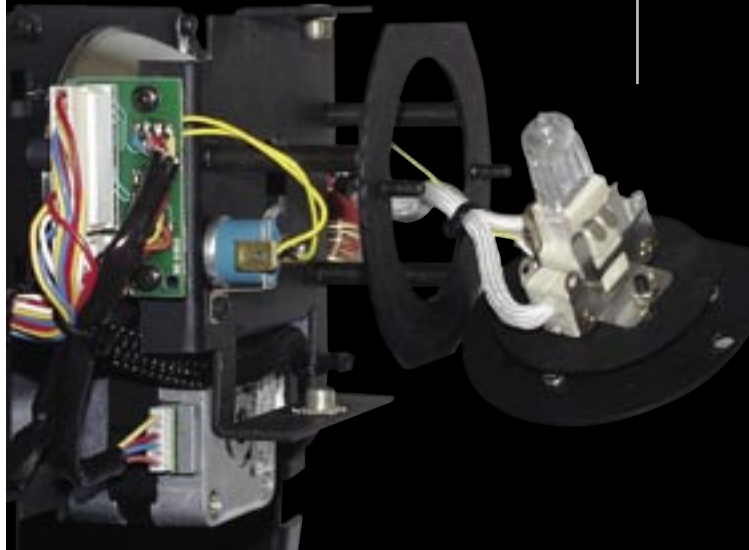



silent and
precise ...

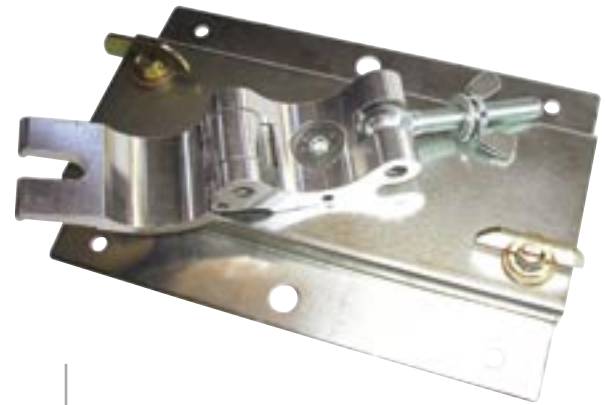

The optional fast fixing bracket kit (art. SH150 bracket) and the optional aluminium clamp (art. SINGLE clamp) to hang the spot to any structure and regulate its position.

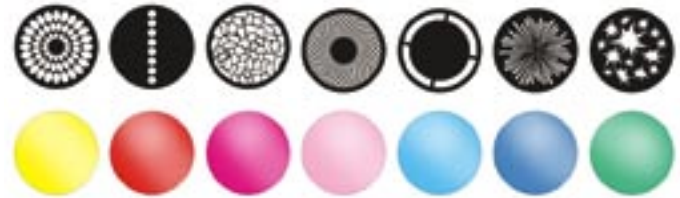

All movements take place by using stepper motors run in microstep mode and controlled by a microprocessor in PWM technique, thus guaranteeing smooth, fast and precise motions. The transmission of the PAN/TILT movement is achieved through a belt kept in tension by spring system thus enabling a silent and precise motion.

